

Sukup® Drive-Over Hopper



Fast, Convenient, Portable Unloading



Model S7100 Drive-Over Hopper for Permanent Installations:

- Capacity of up to 10,000 Bu/Hr.
- Dual roller chains with UHMW paddles
- 10” overall height
- Weight: 3000 lbs.
- Splash guard keeps grain contained in the center dump area
- Bolt-on end cover can be easily removed for service and clean-out
- Jackshaft reduction drive
- Optional 30” spout extension may be added

Movable Model S7000 features all of the above, plus:

- Spring-loaded ramps that can be easily raised and lowered by one person
- Ramps can be easily removed
- Hitch folds up and out of the way when not in use
- 13” tires
- Hitch jack is standard

Capacities	
Max Bu/Hr.	Motor HP
3500	3
5000	5
7000	7.5
10,000	10



Excellent Capacities

The Sukup Drive-Over Hopper is designed to maintain maximum capacity.

- Grain falls through to completely fill the bottom of paddle sections.
- The top chain levels off the grain before it reaches the throat, helping to prevent plugging.
- The divided throat (shown in red) “captures” the grain, so it can’t flow backward while ascending to the discharge.

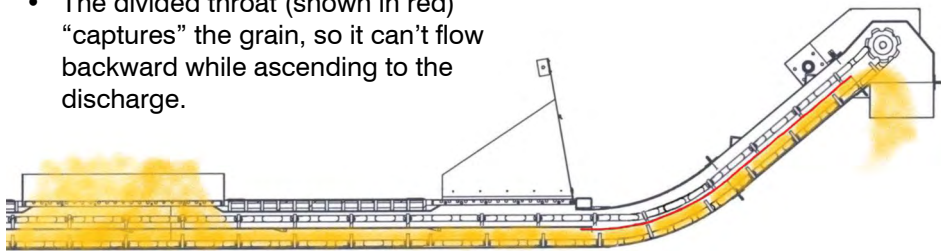

Clean-Out

For those operations in which it is critical to get the hopper thoroughly cleaned out, Sukup designed a unit with few places for grain to accumulate.

- The UHMW paddles run the full width between the chains, so there is little area for grain to accumulate.
- Minimum paddle clearance on the take-up end means there is less grain to clean out.
- The end cover is quickly removed for easy clean-out when operation is complete.



Bottom Dump or Side-Discharge Unloading

The Sukup Drive-Over Hopper can be used with bottom-dump trailers or side-discharge grain wagons.

- The center dump area is a large 32” x 48”.
- Rubber belting splash guard keeps grain contained to the dump area.
- Converts instantly to a side-unload unit.
- Side-discharge cover doubles as a splash guard to keep grain confined in the dump area.



Rugged Construction

The Sukup Drive-Over Hopper is ruggedly built to withstand the stress of years of use.

- Drive-over grates are reinforced.
- Ramp surfaces are made of extra-heavy diamond decking for durability and traction.
- Unit weighs 3000 lbs.



Quick Conversions

The Sukup Drive-Over Hopper quickly converts from transport to unloading position and back again.

- The wheels are removed after transport with the pull of a pin.
- Ramps are spring-loaded so, even though they are built tough, one person can easily raise and lower them.
- Ramps can be easily removed for those applications where they are not required.



Sukup Manufacturing Co. provides the information contained within this brochure to assist you in choosing the optimal equipment for your situation. Many factors, such as grain variety, maturity levels, grain cleanliness, weather conditions and operation/management, can affect the performance of your equipment and results may vary. This information is calculated and is not a guarantee of product specifications or performance. Based on these factors, Sukup specifications should only be used as estimates, and not as a warranty, expressed or implied, of how a particular Sukup unit will perform under your operating conditions. Because we are continually improving Sukup products, changes may occur that may not be reflected in the specifications.



DANGER! Failure to heed these warnings may result in serious injury or death. Keep away from moving parts. Keep children away when operating. Keep all shields in place. Not intended for highway travel. Maximum speed - 20 mph.

Permanent Installation

Sukup S7100 Drive-Over Hopper

- The S7100 has the same features as the standard Sukup Drive-Over Hopper, including: dual roller chains and UHMW paddles, rugged construction and excellent capacities.
- Since it is designed for permanent installation, the S7100 does not include transport components such as ramps, transport wheels and assembly, jack and tongue.

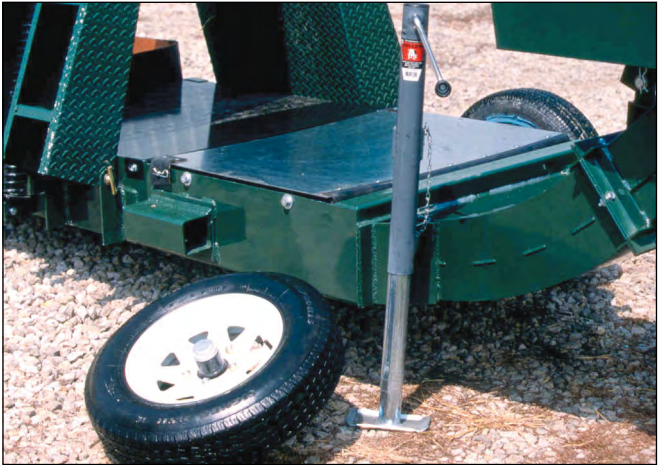

Options

- Choice of four motor and drive packages - 3, 5, 7.5, or 10 hp.
- Hydraulic drive kit is available for running the hopper in locations without electricity.
- Flow control is also available for the hydraulic drive.
- A 30” spout extension may be added.

Drive-Over Hopper Dimensions

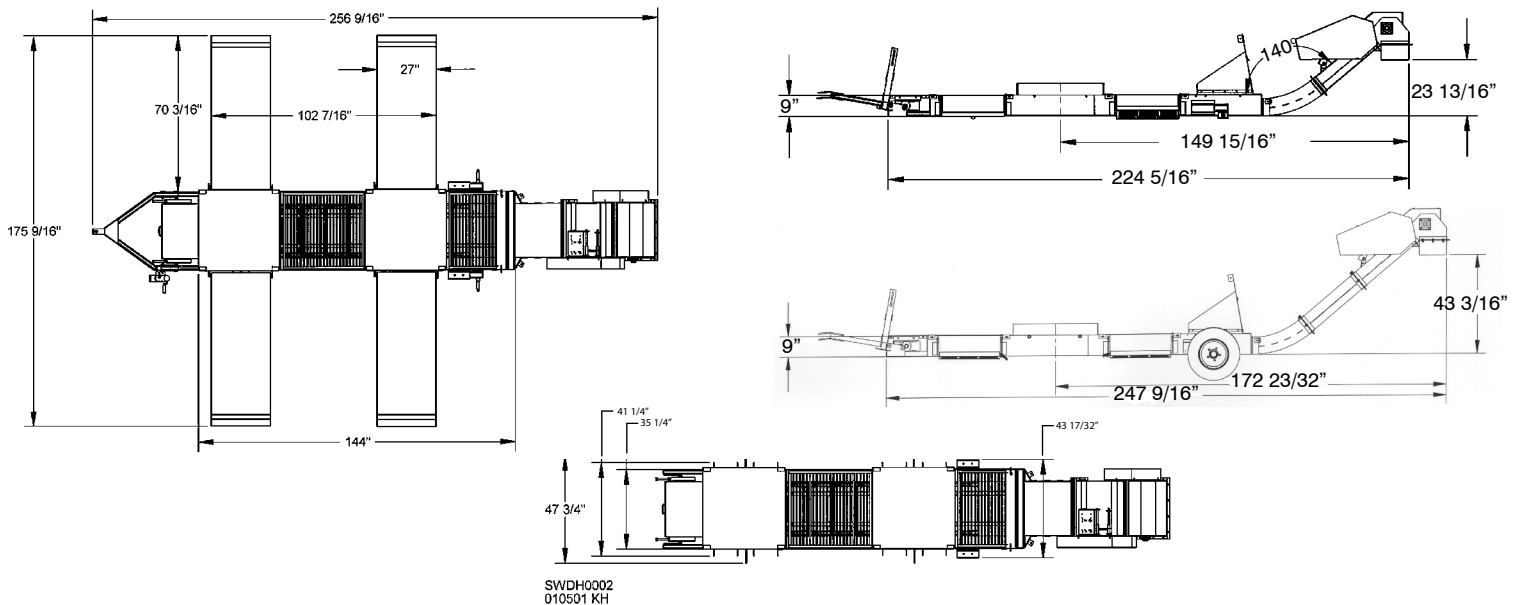

Sukup Solutions™

Sukup manufactures a full line of grain drying and handling equipment to fill your Sukup Grain Bin with quality: *quality equipment and quality grain.*

Drying

Axial & Centrifugal Dryers, Tower Dryers, Airway® Tubes, Axial & Centrifugal Fans & Heaters, Fastir™ Stirring Machines

Storage

Farm & Commercial Grain Bins, Heavy-Duty & Medium-Duty Hopper Bins, Floors & Supports, Aeration Fans, Pre-Engineered Metal Buildings

Handling

Sweepway™ Power Sweep, Cyclone Pneumatic Systems, Drag & Hy-Flight Conveyors, Chain Loop & Double Run Conveyors, Bucket Elevators, Drive-Over Hoppers



Sukup Manufacturing Co ■ www.sukup.com
Box 677 ■ 1555 255th St. ■ Sheffield, IA 50475-0677 ■ ph 641.892.4222 ■ fx 641.892.4629 ■ info@sukup.com

Distribution Centers

Arcola, IL 61910
980 E. State Rte. 133
ph 217.268.3026
illinois@sukup.com

Aurora, NE 68818
1705 Hwy. 34 E.
ph 402.694.5922
nebraska@sukup.com

Cameron, MO 64429
7426 NE 352nd St.
ph 816.649.2226
missouri@sukup.com

Defiance, OH 43512
7724 Rte. 66 N.
ph 419.784.9871
ohio@sukup.com

Jonesboro, AR 72403
5917 E. Johnson Ave.
ph 870.932.7547
arkansas@sukup.com

Watertown, SD 57201
2701 Piper Ave.
ph 605.882.6697
southdakota@sukup.com

L1152-052012A

© Copyright 2012. This information contained herein is the exclusive property of Sukup Manufacturing Co